

12 WATER PRESSURE SYSTEM AND PUMPS



- Hand pumps
- Bilge pumps
- Bronze pumps
- Diaphragm pumps
- Water pressure system
- Floating switches
- Filters
- Electrovalves

aber
marine

GIANNESCHI
pumps and blowers

JABSCO

rule

FLOJET

MARCO

12

REBAMARINE

NAUTICAL EQUIPMENT



MANUAL PUMP WARRIOR

For mounting on deck
In a very robust alloy
Double diaphragm design gives maximum efficiency
45cm handle
High delivery

Model	Delivery	Ports mm inches	Inlet hole	Wall thickness	Dimensions of the Visible parts	Code
WARRIOR	135l/min	38 1,5	86 mm	5 - 22 mm	129 x 120 x 14,5 mm	RE 80027
Service Kit						RE 80027/K



MANUAL PUMP UNIVERSAL

For mounting on bulkhead, through bulkhead, on deck or through deck
Flow rate up to 25gpm
28cm handle
High delivery

Model	Delivery	Ports mm inches	Inlet hole	Wall thickness	Dimensions of the Visible parts	Code
UNIVERSAL	100l/min	38 1,5	86 mm	5 - 22 mm	129 x 120 x 14,5 mm	RE 80045
Service Kit						RE 80045/K



MANUAL PUMP THRUDECK

For on deck mounting
28cm handle

Model	Delivery	Ports mm inches	Inlet hole	Wall thickness	Dimensions of the Visible parts	Code
THRUDECK	50l/min	25 1	86 mm	5 - 22 mm	129 x 120 x 14,5 mm	RE 80040
Service Kit						RE 80040/K



MANUAL PUMP BULKHEAD

For mounting through deck or through bulkhead
Compact pump
Right for small vessels

Model	Delivery	Ports mm inches	MAX dimensions of the pump	Level Angle	Code
BULKHEAD	45l/min	25 1	176 x 204 x 120 mm	40°	RE 80041
Service Kit					RE 80041/K



HAND PUMPS EXCELSIOR

Double acting semi rotary hand wing pumps
High manometric head
Body pump on cast iron, internal parts on bronze

Model	Delivery	Ports mm inches	MAX dimensions of the pump	Weight	Code
EXCELSIOR 5	30l/min	- 1 1/2"	287 x 320 x 185 mm	-	RE 80129



CENTRIFUGAL MOTOR PUMPS



SELF PRIMING CENTRIFUGAL MOTOR PUMPS

Self-priming el/pumps "ACB series"

Supplied with star impeller (ACB 331 - ACB 332 - ACB 431 series)

APPLICATIONS: bilge, chain washing, fire-fighting,
intake diesel oil and liquids

High self-priming capacity (up to 9m)

Body pump: bronze

Star impeller: in a special brass alloy

Shaft: AISI 316 stainless steel

Mechanical seal of high quality thanks to stainless steel, graphite and ceramic
We suggest to install a filter and a clapet valve on the suction pipe

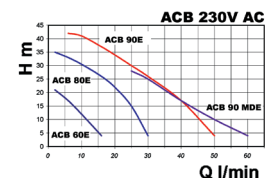
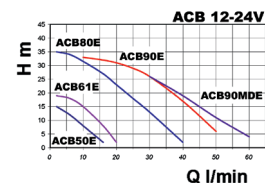

Model	Voltage V	Power Kw	Absorp A	RPM	Max Delivery L/min	Prev. MAX m	Ports inches	Dimensions H x L x D mm	Weight Kg	Code
ACB 61 G	230	0,25	-	2900	20	19	1/2"	115x120x255	10	RE 80332
ACB 61 G	12	0,18	15	3200	20	21	1/2"	105x125x225	7	RE 80091/12
ACB 61 G	24	0,18	7,5	3200	20	21	1/2"	105x125x225	7	RE 80091/24
ACB 61 RG	24	0,25	11	3400	20	26	1/2"	127x140x210	8	RE 80335
ACB 80 E	12	0,37	31	3000	50	34	3/4"	160x155x326	12	RE 80336
ACB 80 E	24	0,37	15	3000	50	34	3/4"	160x155x326	12	RE 80249
ACB 80 E	230	0,37	-	2800	40	36	3/4"	161x134x300	11	RE 80161
ACB 80 E	230/400	0,37	-	2800	40	36	3/4"	161x134x300	11	RE 80337
ACB 90 E	24	0,44	18	2800	50	35	1"	185x155x340	15	RE 80209
ACB 90 E	230	0,55	-	2800	50	42	1"	183x136x315	14	RE 80213
ACB 90 E	230/400	0,55	-	2800	50	42	1"	183x136x315	14	RE 80338

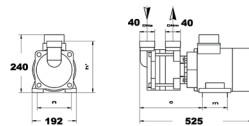
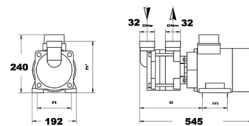
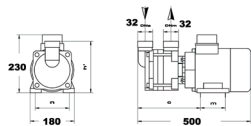
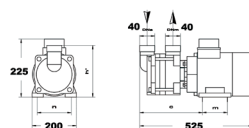
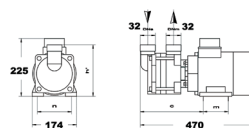
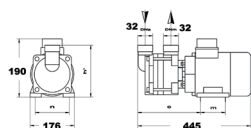

ACB 331 - ACB 332 - ACB 431

Model	Voltage V	Power Kw	Absorp A	RPM	Max Delivery L/min	Prev. MAX m	Ports inches	Dimensions H x L x D mm	Weight Kg	Code
ACB 331-1	24	0,9	38	1500	150	25	1" 1/4"	190x175x445	28	RE 80339
ACB 331-2	24	1,1	46	1500	150	33	1" 1/4"	217x175x470	35	RE 80340
ACB 331-B	230	1,5	-	1450	140	36	1" 1/4"	255x175x465	30	RE 80341
ACB 331-B	230/400 T	1,5	-	1450	140	36	1" 1/4"	225x175x465	30	RE 80342
ACB 332	24	1,5	-	1500	130	45	1" 1/4"	300x200x540	45	RE 80355
ACB 332-B	230	2,2	-	1450	140	55	1" 1/4"	270x193x530	38	RE 80343
ACB 332-B	230/400 T	2,2	-	1450	140	55	1" 1/4"	240x193x530	38	RE 80344
ACB 431	24	1,5	63	1500	230	30	1" 1/2"	225x220x530	40	RE 80345
ACB 431-C	230/400 T	3	-	1450	210	46	1" 1/2"	260x200x525	45 - 47	RE 80361
ACB 431-B	230	2,2	-	1450	210	35	1" 1/2"	290x200x525	46	RE 80346
ACB 431-B	230/400 T	2,2	-	1450	210	35	1" 1/2"	260x200x525	46	RE 80347

SELF PRIMING MOTOR PUMPS

SELF PRIMING MOTOR PUMPS

APPLICATIONS: intake diesel oil, intake liquids (sea and fresh water)

Grey water discharge (galley and shower), bilge

Self-priming REVERSIBLE el/pumps Supplied with star impeller (possible to invert the flow)

High self-priming capacity (up to 9m)

(Excluded CP20G and CP30G model)

Body pump and star impeller in bronze

Shaft: AISI 316 stainless steel

Mechanical seal of high quality thanks to stainless steel, graphite and ceramic

We suggest to install a filter and a clapet valve on the suction pipe



RE 80354

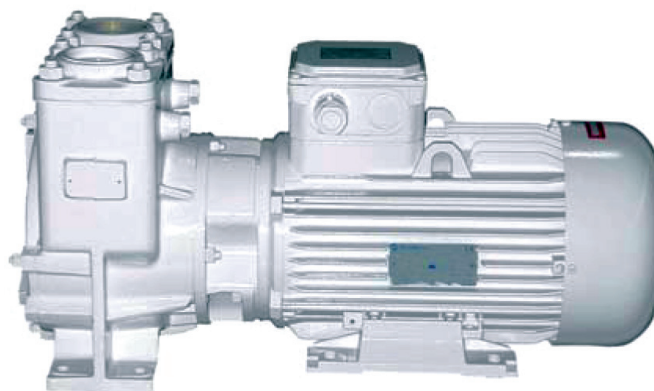

RE 80356

CP 12V - CP 24V

Model	Voltage V	Power Kw	Absorp. A	RPM	Max Delivery L/min	Prev. MAX m	Ports inches	Dimensions mm	Weight Kg	Code
CP20/A1	12	0,20	28	2600	45	11	3/4"	150x120x210	7	RE 80348
CP20/A1	24	0,18	13	2800	45	12	3/4"	143x120x235	6	RE 80349
CP20/A2	24	0,30	18	2800	60	13	3/4"	150x120x210	7	RE 80351
CP26/A2	12	0,37	46	1600	75	15,5	1"	160x140x300	11	RE 80352
CP26/A2	24	0,37	22	1600	75	16,5	1"	160x140x300	10	RE 80083
CP26/A1	24	0,20	16	1500	60	12	1"	160x140x300	9	RE 80354
CP30/A1	24	0,45	28	1500	90	20	1"	190x140x355	14	RE 80289
CP40	24	0,75	45	1500	145	16	1 1/2"	215x180x370	26	RE 80218
CP40-100	24	1,5	85	1400	265	20	1 1/2"	255x190x490	51	RE 80356

CP 230V 50HZ MONOPHASE

Model	Voltage V	Power Kw	Hz	RPM	Max Delivery L/min	Prev. MAX m	Ports inches	Dimensions mm	Weight Kg	Code
CP20 G	230	0,25	50	2800	60	14	3/4"	143x120x260	6,5	RE 80357
CP26/A1	230	0,37	50	1450	60	16	1"	160x140x300	12	RE 80358
CP40	230	1,1	50	1450	175	14	1 1/2"	215x180x370	28	RE 80359
CP40-140	230	2,2	50	1450	300	20	1 1/2"	255x190x455	48	RE 80362

ON REQUEST 230 / 400V three-phase or 60Hz

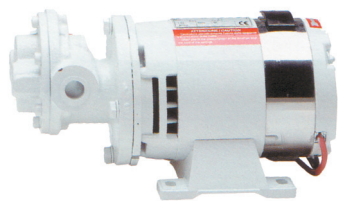

PQ 20

SELF-PRIMING GEAR PUMPS

Applications: Intake of lubricant and diesel oil, fuel and similar liquids up to 6°E viscosity (only for model IN12)

Body pump: Cast iron – Gears: steel – enbloc with special shaft

“IN” SERIES

Model	Voltage V	Power KW	Absorp MAX	Delivery l/min	Ports inches	Manom H. m	Dimensions mm	Weight kg	Code
IN 12	12	0,25	32 A	10	1/2”	20	140x140x285	8	RE 80263
IN 12	24	0,25	12 A	10	1/2”	20	140x140x285	8	RE 80264

“PQ” SERIES

Model	Voltage V	Power KW	RPM	Delivery L/min	Ports inches IN OUT	Manom H. m	Dimensions mm	Weight Kg	Code
PQ 15	24	0,37 Kw	1450	15	1/2” 1/2”	50m	155x185x415	18	RE 80380
PQ 20	24	0,55 Kw	1450	20	3/4” 3/4”	50m	155x185x460	20,0	RE 80382
PQ 30	24	0,75 Kw	1450	30	3/4” 3/4”	50m	195x205x515	30,0	RE 80381
PQ 40	230	1,1 Kw	1450	40	1” 1”	50m	220x205x550	35	RE 80383
PQ 50	230	1,1 Kw	1450	50	1” 1”	50m	240x205x550	37	RE 80384
PQ 60	230	1,5 Kw	1450	60	1” 1”	50m	250x210x565	40	RE 80385
FQ 50	230	1,1 Kw	1450	50	1” 1”	50m	195x153x542	23	RE 80331

CB SERIES CENTRIFUGAL ELECTRIC PUMPS

CONTINUOUS DUTY, NOT SELF-PRIMING

Applications: distribute clean water (fresh or sea water) at continuous duty, sanitary plants, conditioning system, water supply, heating, cooling and circulation plants

Body pump: bronze. Impeller: special brass alloy. Shaft: AISI 316 stainless steel

Mechanical seal: high quality on ceramic, graphite inox

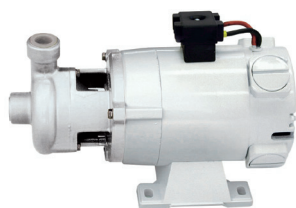

CB 24V

Model	Voltage V	Power KW	Absorp MAX	Delivery l/min	Ports inches	Manom H. m	Dimensions mm	Weight kg	Code
CB 160 RE	24	0,2	8	40	1/2”	7	135x125x270	5	RE 80252
CB 22 -120 E	24	0,55	32	125	1”	23	160x175x330	12	RE 80254
CB 25/16 B	24	1,1	60	200	1”	29	290x200x380	25	RE 80256



CB 230V 50HZ

Model	Voltage V	Power Kw	Delivery L/min	Ports inches IN OUT	Manom H. m	Dimensions mm	Weight Kg	Code
CB 160 E	230	0,15	40	1/2” 1/2”	5	135x125x270	5	RE 80376
CB 22 -120 E	230	0,55	100	1” ”	21	160x175x330	12	RE 80378
CB 25/16B	230	1,1	160	1” 1/2” 1”	31	290x200x380	25	RE 80379
CB 25/16B	230/400 T	1,5	160	1” 1/2” 1”	31	290x200x380	25	RE 80333



CC DIRECT CURRENT ENGINES

Applications: cooling plants, compressor, pumps, blowers and traction system With permanent magnet motor. The full-load torque is up to 10 times the nominal torque. Degree of protection: IP22

Model MP	Voltage V	Power KW	Absorp MAX	RPM	IP	Dimensions mm	Weight kg	Code
MP 71 S2	12	0,3	18 A	1500	22	128x145x195	5	RE 80260
MP 71 S2	24	0,3	8 A	1500	22	128x145x195	5	RE 80261
MP 71 M4	24	0,3	19 A	1500	22	128x145x256	8,5	RE 80262

SINGLE SCREW MOTOR DRIVEN PUMPS

SINGLE SCREW MOTOR DRIVEN PUMPS MVG SERIES

FOR SOLID LIQUID

Applications: emptying of waste, gravel pump, to pump liquid with small part in suspension

Positive displacement pumps with a metal single-thread helical rotor

Body pump: bronze

Screw rotor: AISI 316 stainless steel

It is important to check the rotation sense to avoid the rotor to unscrew in case working in the anti-clockwise sense

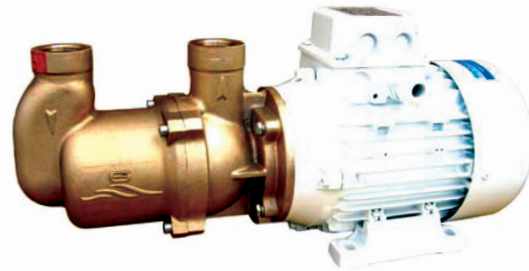
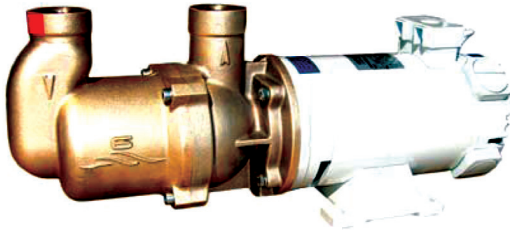

Model	Voltage V	Power Kw	Absorp A	RPM	Max Delivery L/min	Prev.MAX m	Ports inches	Dimensions mm	Weight Kg	Code
MV44G	12	0,30	38	1450	50	28m	1"	171x145x428	17	RE 80365
MV44G	24	0,30	19	1450	50	28m	1"	171x145x428	17	RE 80099
MV44G	230	0,55	-	1450	50	40m	1"	204x155x443	15,5	RE 80366
MV44G	230/400 T	0,55	-	1450	50	40m	1"	204x155x443	15,5	RE 80367



SINGLE SCREW MOTOR DRIVEN PUMPS

FOR SOLID LIQUID

These el/pumps are positive displacement pumps.

They are based on a metal single-threaded helical rotor.

Turning in a rubber double-thread helical stator.

The pump can carry all kinds of fluids,

dirty, viscous and with small parts in suspension.

Being a self-priming pumps, it is necessary, only at the first start to.

Fill the body pump of water to lubricate the stator and to have the priming.

We suggest to install a clapet no-return valve on the suction pipe.

On request available for diesel transfer.

Model	Voltage V	Power Kw	RPM	Max Delivery L/min	Press Bar	Ports inches	Dimensions mm	Weight Kg	Code
MVI 60	24	0,88	1450	55-51	1-2	1" 1/2"	193x200x565	26	RE 80368
MVI 60	230	1,1	1450	55-45	1-3	1" 1/2"	223x200x580	24	RE 80369
MVI 60	230/400 T	1,1	1700	55-45	1-3	1" 1/2"	233x200x580	24	RE 80370
MVI 80	24	1,1	1450	95-61	1-3	2"	240x200x660	33	RE 80371
MVI 80	230	1,5	1450	98-64	1-3	2"	235x200x660	30	RE 80372
MVI 80	230/400 T	1,5	1700	98-64	1-3	2"	235x200x660	30	RE 80373
MVI 100	230/400 T	1,5	1500	130-90	1-2	2"	235x200x670	35	RE 80375

NB: IN CASE OF ASPIRATION FROM ABOVE an elbow pipe can be supplied

CENTRIFUGAL MOTOR PUMPS

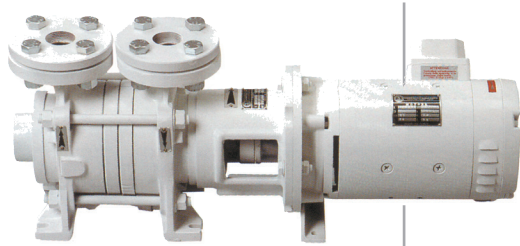

ACM-BT SERIES CENTRIFUGAL ELECTRIC PUMPS

SELF PRIMING IN BRONZE

Whit star impeller and an outstanding self priming capacity

APPLICATIONS: bilge, chain washing, fire-fighting, intake diesel oil and liquids system supplying. Body pump: bronze. Impeller: bronze

Shaft: AISI 316 stainless steel

Mechanical seal of high quality thanks to stainless steel, graphite and ceramic
We suggest to install a filter and a clapet valve on the suction pipe

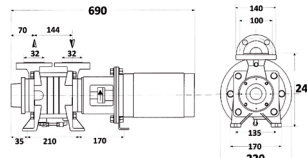
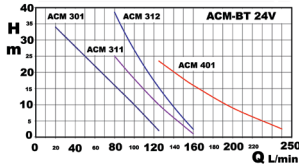

RE 80251

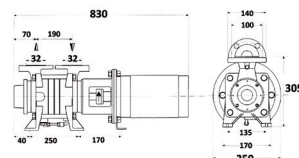

RE 80321

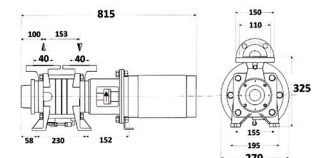

RE 80322

ACM-BT 24 DIRECT CURRENT

Model ACM-BT	Voltage V	Power Kw	Absorp MAX	RPM	Max Delivery L/min	Ports mm	Max Manometric Head m	Dimensions mm	Weight Kg	Code
ACM 311BT	24	1,5	60	1500	150	32	25	247x200x700	65	RE 80251
ACM 312BT	24	1,5	90	1500	130	32	46	247x250x790	75	RE 80321
ACM 401BT	24	1,5	90	1500	230	40	30	272x250x800	80	RE 80322

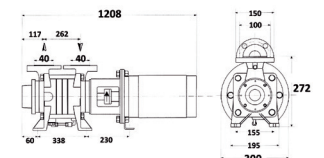
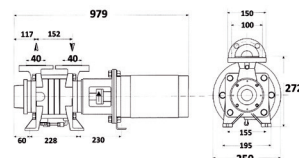
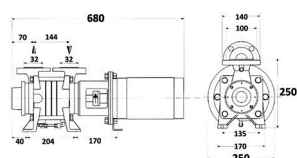
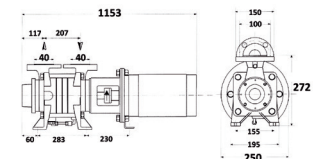
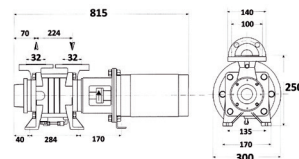
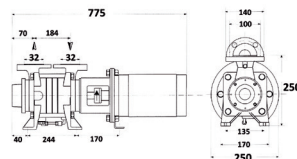
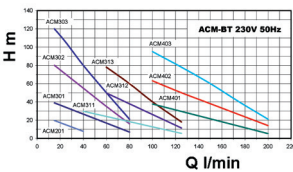

ACM-BT ALTERNATING CURRENT

Model ACM-BT	Voltage V	Power Kw	Absorp MAX	RPM	Max Delivery L/min	Ports mm	Max Manometric Head m	Dimensions mm	Weight Kg	Code
ACM 311BT	220	1,1	50 Hz	1450	130	32	30	247x210x660	55	RE 80163
ACM 312BT	220	2,2	50 Hz	1450	140	32	55	247x260x780	70	RE 80326
ACM 313BT	220	3	50 Hz	1450	130	32	78	247x260x830	76	RE 80327
ACM 401BT	220	2,2	50 Hz	1450	210	40	38	270x260x770	70	RE 80328
ACM 402BT	230/400 T	4	50 Hz	1450	210	40	70	270x285x860	85	RE 80329
ACM 501BT	230/400 T	4	50 Hz	1450	400	50	36	325x285x820	90	RE 80323
ACM 502BT	230/400 T	9,2	50 Hz	1450	400	50	83	325x320x1100	125	RE 80324

60Hz or TRIPHASE ENGINE AVAILABLE ON REQUEST

WATER PRESSURE SYSTEM

WATER PRESSURE SYSTEM WITH AUTOMATIC RUNNING

Applications: pressure water distribution on board.

Supplied with manometer, pressure switch and no-return valve.

The tank is supplied with the stainless steel AISI 316 flange and the butyl rubber fixed membrane anti-water hammer.

Self-priming electric pump with star impeller (quick priming).

Body pump: bronze.

Impeller: special brass alloy.

Shaft: AISI 316 stainless steel.



IDROMINI ACB

Model	Volt V	Power Kw	Absorp A	Sheet tank	Ports inches	Delivery L/min	Press max	Pressure Switch adg	Dimensions mm	Weight Kg	Code
ACB61 G	12	0,15	18	2L	1/2"	22	2,2	0,9-1,6	240x180x300	9	RE 80281
ACB61 G	24	0,15	8	2L	1/2"	22	2,2	0,9-1,6	240x180x300	9	RE 80255
ACB80 E	24	0,37	22	5L	3/4"	50	3	1,4-2,8	350x170x410	18	RE 80350

IDROMINI ECOJET

Model	Volt V	Power Kw	Absorp A	Sheet tank	Ports inches	Delivery L/min	Press max	Pressure Switch adg	Dimensions mm	Weight Kg	Code
ECOJET	12	0,30	30	5L	1"	45	2,6	1,2-2	130x190x525	15	RE 80093/12
ECOJET	24	0,30	16	5L	1"	45	3	1,4-2,4	130x190x525	15	RE 80093/24
ECOJET 2	230	0,37	-	5L	1"	55	2,5	1,5-2,8	130x190x525	15	RE 80353

IDRO ECOJET

Model	Volt V	Power Kw	Absorp A	Sheet tank	Ports inches	Delivery L/min	Press max	Pressure Switch adg	Dimensions mm	Weight Kg	Code
ECOJET 1B	12	0,30	30	20 L	1"	45	2,6	1,2-2	600x255x590	19	RE 80316
ECOJET 1B	24	0,30	16	20 L	1"	45	3	1,4-2,4	600x255x590	19	RE 80317
ECOJET 2B	24	0,37	21	20 L	1"	55	3,5	1,5-2,8	590x255x590	20	RE 80318
ECOJET 2B	230	0,45	-	20 L	1"	55	3,5	1,5-2,8	590x255x590	20	RE 80319

B version for fresh water ; on request BB series for sea water



SELF-PRIMING MOTOR PUMPS "ECOJET"

Applications: chain washing, fire fighting, water lifting, conditioning system, supply WC

The jet electric pumps series have a closed impeller Have an outstanding self-priming capacity

Body pump: bronze – Flange: Stainless steel Impeller: special brass alloy

Shaft: AISI 316 stainless steel. Mechanical seal: High quality on ceramic

Model	Volt V	Power Kw	Absorp MAX	Delivery l/min	Ports inches	Preval. m	Dimensions mm	Weight Kg	Code
ECOJET 1B	24	0,3	16	50	1"	28	158x160x400	11	RE 80268
ECOJET 2B	230	0,5	-	50	1"	36	158x160x400	12	RE 80269
JET 3B	24	0,55	36	70	1"	42	195x185x480	23	RE 80392
JET 4B	24	0,75	42	90	1"	35	195x185x485	24	RE 80393
JET 518	24	1,1	60	100	1" and 1,5"	47	225x215x630	39	RE 80394

B version for fresh water. On request BB series for sea water

WATER PRESSURE SYSTEM



WATER PRESSURE SYSTEM "IDRO ECOINOX" SERIES

Applications: pressure water distribution on board
 Supplied with manometer, pressure switch and no-return valve
 The tank is supplied with the stainless steel AISI 316 flange and the butyl rubber fixed membrane anti-water hammer
 Self-priming electric pump with star impeller (quick priming)
 Body pump: Steel – Impeller: tecnopolimere – Shaft: AISI 316 stainless steel

Model	Volt V	Power Kw	Absorp. A	Tank INOX 304	Ports inches	Delivery L/min	Press MAX	Pressure Switch adg	Dimensions mm	Weight Kg	Code
ECOINOX 1	12	0,30	30	20 L	1"	45	2,6 bar	1,2-2 bar	600x255x590	19	RE 80320
ECOINOX 1	24	0,30	16	20 L	1"	45	3 bar	1,4-2,4 bar	600x255x590	19	RE 80386
ECOINOX 2	24	0,37	21	20 L	1"	55	3,5 bar	1,5-2,8 bar	590x255x590	20	RE 80090
ECOINOX 2	230	0,45	-	20 L	1"	55	3,5 bar	1,5-2,8 bar	590x255x590	20	RE 80300

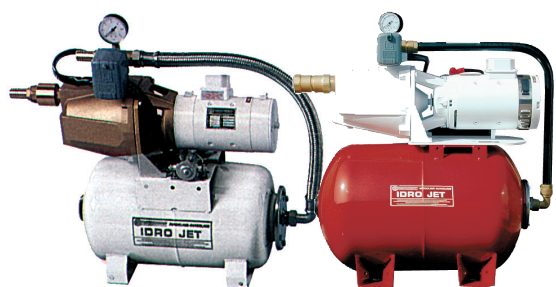

WATER PRESSURE SYSTEM "IDROJET"

Applications: pressure water distribution on boat
 Supplied with relays, manometer, pressure switch and non-return valve
 The tank is supplied with the stainless steel flange and the butyl rubber fixed membrane anti-water hammer. Self priming el/pump with star impeller
 Body pump: bronze – Impeller: special brass alloy – Shaft: stainless steel aisi 316

IDROJET (20 L)

Model	Volt V	Power Kw	Absorp A	Steel tank	Ports IN - OUT	Delivery L/min	Press MAX	Pressure Switch adg	Dimensions mm	Weight Kg	Code
IDROJET 3	24	0,55	36	20 L	1" - 1"	70	4,2 bar	1,8-3,2 bar	610x255x650	33	RE 80387
IDROJET 3	230	0,55	-	20 L	1" - 1"	70	4,2 bar	1,8-3,2 bar	610x255x650	33	RE 80388
IDROJET 4	24	0,75	42	20 L	1" - 1"	80	3,5 bar	1,6-3 bar	610x255x650	33	RE 80272
IDROJET 4	230	0,75	-	20 L	1" - 1"	80	3,5 bar	1,6-3 bar	610x255x650	33	RE 80280
IDROJET 4R	24	0,85	50	20 L	1" - 1"	90	4,5 bar	2,5-3,5 bar	610x255x650	35	RE 80389
IDROJET 518	24	1,1	60	20 L	1" 1/2" - 1"	100	4,7 bar	2,5-3,9 bar	660x360x800	40	RE 80390
IDROJET 518	230	1,1	-	20 L	1" 1/2" - 1"	100	4,7 bar	2,5-3,9 bar	660x360x800	40	RE 80391



CONTROL PRESS WATER PRESSURE SYSTEM

Electronic control: continuous pump running that avoid the "stop and go"
 Cylindrical tanks are not necessary
 Applications: pressure water distribution on board
 Self diagnosis with alarm and three LED's for status indication (red, orange and green)
 Automatic stop in case of no water
 Automatic starting of the pump at the minimum value prefixed
 It is suitable to install a flexible pipe on delivery point

Model	Volt V	Power Kw	Absorp. MAX	Delivery L/min	Ports inches	Press MAX	Dimensions mm	Weight Kg	Code
ECOJET 1B C.E.	12	0,3	30 A	45 l/min	1"	3	480x230x425	13	RE 80270
ECOJET 2B C.E.	24	0,37	22 A	55 l/min	1"	3,5	480x230x425	13	RE 80271
ECOINOX 1 C.E.	12	0,3	-	45 l/min	1"	3	470x230x425	8	RE 80395
ECOINOX 1 C.E.	24	0,3	-	45 l/min	1"	3	470x230x425	8	RE 80396
ECOINOX 2 C.E.	24	0,37	-	55 l/min	1"	3,5	470x230x425	9	RE 80397
ECOINOX 2 C.E.	230	0,37	-	55 l/min	1"	3,5	470x230x425	9	RE 80398
JET 4B	24	0,75	42 A	80 L/min	1"	3,5	480x260x500	22	RE 80399
JET 4B	220	0,75	-	80 l/min	1"	3,5	480x260x500	22	RE 80279

WATER PRESSURE SYSTEM



PAR-MAX WATER SYSTEM PUMPS

Supplied complete with pressure switch and trigger nozzle. Silent and continuous rating
You don't need to install the tank anymore

Chamber with 3 valves (mod. PAR-MAX 1.9 and 2.9)

Hose barb fittings or female hose barb

Thermal overload protection (PAR-MAX 1-3-4)

WATER SYSTEM PUMPS 12V

Model	Volt. V	Delivery MAX	Absorp A	Ports mm inches	Press Bar	Manom. H. m	Dimensions mm	Weight kg	Code
PAR-MAX 1	12	4,3 l/min	1,9	9,5 3/8"		1	157 x 89 x 58	0,6	RE 80220
PAR-MAX 1,9	12	7 l/min	3,5	13 1/2"		1,8	229 x 105 x 121	1,4	RE 80014
PAR-MAX 2,9	12	11 l/min	4,4	13 1/2"	1 - 1,7	3	229 x 105 x 121	1,6	RE 80223



WATER SYSTEM PUMPS 24V

Model	Volt. V	Delivery MAX	Absorp A	Ports mm inches	Press Bar	Manom. H. m	Dimensions mm	Weight kg	Code
PAR-MAX 1,9	24	7 l/min	1,7	13 1/2"		1,8	229 x 105 x 121	1,4	RE 80015
PAR-MAX 2,9	24	11 l/min	2,2	13 1/2"	1 - 1,7	3	229 x 105 x 121	1,6	RE 80224



40 PSI WATER SYSTEM PUMPS 12V

Model	Nominal Voltage	Max Flowrate	Max Draw	Port Fittings x2 mm inches	Press. bar	Dimensions mm	Weight kg	Code
PAR-MAX 4HD	12	15 lt/min.	10A	13 1/2"	2,8	239x97x109	2,5	RE 80038
PAR-MAX 5HD	12	19 lt/min.	12A	13 1/2" 19 3/4"	2,8	244x127x119	3	RE 80225
PAR-MAX 6HD	12	23 lt/min.	15A	19 3/4"	2,8	260x129x119	3,2	RE 80226

40 PSI WATER SYSTEM PUMPS 24V

Model	Nominal Voltage	Max Flowrate	Max Draw	Port Fittings x2 mm inches	Press. bar	Dimensions mm	Weight kg	Code
PAR-MAX 4HD	24	15 lt/min.	10A	13 1/2"	2,8	239x97x109	2,5	RE 80039
PAR-MAX 5HD	24	19 lt/min.	12A	13 1/2" 19 3/4"	2,8	244x127x119	3	RE 80227
PAR-MAX 6HD	24	23 lt/min.	15A	19 3/4"	2,8	260x129x119	3,2	RE 80228



WATER PRESSURE PUMP VFLO 5.0

Constant pressure water pumps - Feature the revolutionary new DiMOND technology designed to automatically diagnose and monitor all aspects of your pump's performance to prevent system failure

Voltage V	Flow L/min	Absorption A	Port Type mm inches	Pressure Bar	Code
12	19	15	13 1/2"	25	RE 80148
24	19	10	13 1/2"	25	RE 80230

WATER PRESSURE SYSTEM

FLOJET



FLOJET PRESSURE CONTROLLED PUMPS

Compact. Silent
Low absorption
Duplex diaphragm design
For intermittence use
They don't need an accumulator tank

Model	Volt V	Delivery MAX	Absorp a 0,7 bar	Ports		Press. button		Dimensions mm	Weight kg	Code
				mm	inches	ON	OFF			
LF 12-22	12	4,3 l/min	1,9 A	9,5	3/8	1,5 bar	2,4 bar	162 x 89 x 58	0,6	RE 80231



TRIPLEX AUTOMATIC WATER SYSTEM PUMP

Three chamber diaphragm design
Self priming up to 3m suction lift
Anti-vibration system, very silent
Special "snap-in" port fitting
Pump able to run dry without damage
Meets ISO 8846

Model	Volt V	Delivery MAX	Absorp a 0,7 bar	Ports		Press. button		Dimensions mm	Weight kg	Code
				mm	inches	ON	OFF			
R3426-148	12	7,6 l/min	3,5 A	12,5	1/2	MAX	1,7 bar	229 x 121 x 152	1,6	RE 80153
R3526-144	12	11 l/min	4,4 A	12,5	1/2	MAX	3,8 bar	229 x 121 x 152	1,6	RE 80154
R3426-344	24	11 l/min	2,2 A	12,5	1/2	MAX	1,7 bar	229 x 121 x 152	1,6	RE 80155



"QUAD II DIAPHRAGM" WATER SYSTEM PUMPS

Four-piston design delivers higher flow rates
High delivery. No pressure switch
Self-priming up to 3m vertical lift
Manometric head 3m
Big ports 19mm ID hose
To combine with accumulator tanks between 8 and 22lt

Model	Volt V	Delivery MAX	Absorp a 0,7 bar	Ports		Press. button		Dimensions mm	Weight kg	Code
				mm	inches	ON	OFF			
4405-143	12	12,5 l/min	3,9 A	12,5	1/2	MAX	2,5 bar	208 x 160 x 95	1,8	RE 80233
4405-343	24	12,5 l/min	2 A	12,5	1/2	MAX	2,5 bar	208 x 160 x 95	1,8	RE 80234
4325-143	12	17 l/min	6 A	19	3/4	MAX	2,8 bar	252 x 160 x 95	2,8	RE 80156
4325-343	24	17 l/min	2,5 A	19	3/4	MAX	2,8 bar	252 x 160 x 95	2,8	RE 80157



DUAL MAX HYDRAULIC SYSTEM

Combined pumps with VSD hydraulic flux and a Par Max 4 System
It can delivery 30 liter/m if needed. Homogenous and balanced flux, as requested
Fixed water pressure
Self-priming pump up to 3m
No accumulator tank requested

Model	Voltage V	Delivery MAX l/min	Dimensions (HxWxD)	Weight Kg	Code
31670-0092	12	30	337 x 356 x 197 mm	6	RE 80192
31670-0094	24	30	337 x 356 x 197 mm	6	RE 80193



BILGE PUMP (NON-AUTOMATIC)

Corrosion resistant, easy cleaning. Powerful and reliable. Fitted base
Non-automatic and automatic model. CE and ISO 8849 approvals

12V PUMPS	Capacity GPH	Capacity Liters/h	Model Rule	Voltage V	Absorp A	Ports mm	Dimensions mm	Pict.	Weight gr	Code
	360	1363	24	12	2,5	19	60,3 x 89 1	1	260	RE 80201
	500	1893	25 D	12	2,5	19	60,3 x 89 1	1	260	RE 80203
	800	3028	20 R	12	4	19	60,3 x 95,2	1	280	RE 80275
	1000	3180	20 A	12	4,5	28,6	73 x 73 x 102	2	400	RE 80205
	1100	4164	27 D	12	5	28,6	60,3 x 108	1	280	RE 80206
	1500	5678	02	12	7	28,6	108 x 152	3	1200	RE 80214
	2000	7561	10	12	12	28,6	108 x 152	3	1300	RE 80215
3700	14350	14A	12	18	38	125 x 185	4	2400	RE 80025	

24V PUMPS	Capacity GPH	Capacity Liters/h	Model Rule	Voltage V	Absorp A	Ports mm	Dimensions mm	Pict.	Weight gr	Code
	500	1893	26 D	24	1,3	19	60,3 x 89 1	1	260	RE 80203/24
	800	3028	21 R	24	2	19	60,3 x 95,2	1	280	RE 80276
	1100	4250	28 D	24	2,5	28,6	60,3 x 108	1	280	RE80206/24
	1500	5800	03	24	3,5	28,6	108 x 152	3	1200	RE 80214/24
	2000	7561	12	24	6	28,6	108 x 152	3	1300	RE 80215/24
	3700	14350	16 A	24	9	38	125 x 185	4	2400	RE 80026
4000	15500	56 D-24	24	10	51	124 x 196	4	2500	RE 80219	



"RULE MATE" BILGE PUMP

No power wasted until the pump activates. They allow a better bilge emptyng. Oval shaped; compact figure.
Feature both a pump and noon-mercury float switch in a single, compact housing.
Right for small vessels

12V PUMPS	Capacity GPH	Capacity Liters/h	Model Rule	Voltage V	Absorp A	Ports mm	Dimensions mm	Pict.	Weight gr	Code
	500	1925	RM 500	12	1,9	19	127 x 101	6	370	RE 80277
	750	2900	RM 7500	12	2,8	19	127 x 101	-	370	RE 80204
	1100	4250	RM 1100	12	3,3	28,6	127 x 101	5	400	RE 80207
	2000	7570	RM 2000	12	12	28,6	160 x 108	-	-	RE 80273

24V PUMPS	Capacity GPH	Capacity Liters/h	Model Rule	Voltage V	Absorp A	Ports mm	Dimensions mm	Pict.	Weight gr	Code
	500	1925	RM 500-24	24	1	19	127 x 101	6	370	RE 80277/24
	750	2900	RM 750-24	24	1,4	19	127 x 101	-	370	RE 80204/24
	1100	4250	RM 1100-24	24	1,4	28,6	127 x 101	5	400	RE 80207/24
	2000	7570	RM 2000-24	24	6	28,6	160 x 108	-	-	RE 80273/24

AUTOMATIC BILGE PUMPS

Fully automatic .computerized. No bilge float switch is necessary
The pumps activates ciclycally each 2,5 min. for only one second for perceiving the water
If there is water, the pump keeps turning and intaking. Low consumption waste for test.



Capacity GPH	Capacity Liters/h	Model Rule	Voltage V	Absorp A	Ports mm	Dimensions mm	Pict.	Weight gr	Code
500	1893	25 S	12	2,5	19	60,3 x 102	7	310	RE 80202
1500	5678	51 S	12	7	28,6	108 x 152	8	2500	RE 80208
3700	14010	55 S	12	15,5	38	124 x 184	9	2500	RE 80278



BILGE PUMPS

Corrosion resistant. Body can be dismantled by a simple snap off movement.
Not automatic models. It can be used a floating switch.
Very silent, body in nylon.

Model	Volt V	Delivery l/m	Absorption A	Ports mm	inches	Dimensions mm	Weight gr	Code
1200	12	27	2	19	3/4"	Ø75 x 105	350	RE 80001
4500	12	75	4	29	1 1/8"	Ø 120 x 145	600	RE 80096
8500	12	140	8	29	1 1/8"	Ø 120 x 165	1800	RE 80002
8500	24	140	4,5	29	1 1/8"	Ø 120 x 165	1800	RE 80003



SUBMERSIBLE BILGE PUMPS

Bilge pumps.
Body in robust ABS, corrosion resistant.

MARCO

Model	Volt V	Prevalence m	Ports mm	Delivery L/min	Absorption A	Fuse A	Dimension mm	Code
UP500	12	4	19	32	2,5	5	94,5 x Ø 59	RE 80470
UP500	24	4	19	32	1,2	3	94,5 x Ø 59	RE 80471
UP1000	12	4	28,6	63	4	10	124,7 x Ø 78	RE 80472
UP1000	24	4	28,6	63	2	5	124,7 x Ø 78	RE 80473
UP1500	12	4	26,5	95	10	20	160 x Ø 96	RE 80474
UP1500	24	4	26,5	95	5	10	160 x Ø 96	RE 80475
UP2000	12	4	31,8	126	12	25	200 x Ø 96	RE 80476
UP2000	24	4	31,8	126	6	15	200 x Ø 96	RE 80477
UP3700	24	5	31,8	233	6	10	202 x Ø 110	RE 80478



AUTOMATIC BILGE PUMP

Compact, all-in-one unit. Integrated snap sensing switch into the pump body
No Mercury. Removable clip on basket design. 3-wire device can be run in auto or manual override mode.
No tools needed for maintenance. Extremely energy efficient. Water-cooled motor for long service intervals
Meets the international standard, ISO 8846 marine.

aber
marine

Model	Volt V	Delivery l/min	Ports Ø mm	Absorption A	Dimensions mm	Code
500	12	32	19	1,8	151x78x95	RE 80122
700	12	60	19	3	151x78x95	RE 80124
700	24	60	19	1,2	151x78x95	RE 80125
1100	12	80	29	4	151x78x95	RE 80126
1100	24	80	29	2,2	151x78x95	RE 80127



SELF PRIMING DIAPHRAGM PUMP

Applications: emptying the bilge
Base and support in Nylon
The pump can work without water for short periods without damage

Model	Volt V	Delivery L	Absorption A	Ports mm	inches	Dimensions mm	Preval. m	Weight gr	Code
Pump	12	18	6,5	19	1/2"	155x100x150	2,5	2500	RE 80006
Pump	24	18	3,5	19	1/2"	155x100x150	2,5	2500	RE 80007



BRONZE "PUPPY" PUMPS

Body in bronze, flexible impeller design, Very robust and silent

Connection for 3/8" BSP male threads (mini puppy)

Connection for 1/2" NPT male threaded (water puppy and maxi puppy)

Model	Voltage V	MAX Delivery l/min	Absorption A	Ports mm	inches	Dimension mm	Weight kg	Code
MINI	12	7 l/min	6	12,5	hose	85 x 110 x 175	2	RE 80144
MINI	24	7 l/min	3	12,5	hose	85 x 110 x 175	2	RE 80145
WATER 2000	12	35 l/min	13	Gas	inches 1/2	86 x 120 x 194	2	RE 80012
WATER 2000	24	35 l/min	7,5	Gas	inches 1/2	86 x 120 x 194	2	RE 80013
MAXI 3000	12	45 l/min	21	Gas	inches 1/2	86 x 120 x 219	3,7	RE 80146
MAXI 3000	24	45 l/min	11	Gas	inches 1/2	86 x 120 x 219	3,7	RE 80147

IMPELLER FOR WATER PUPPY 2000

RE 80012/K



SHOWER DRAIN PUMP

MULTITypeSITIONAL PUMP HEAD

Flexible installation

Compact and simple design

Capable of extensive dry running

Filter less

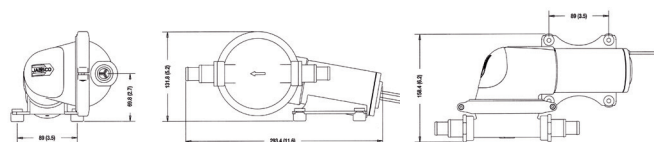

Model	Voltage V	MAX Delivery l/min	Absorption A	Ports mm	inches	Dimension mm	Weight kg	Code
50880	12	14 l/min	8	19	3/4	293 x 131 x 158	2	RE 80188
50880	24	14 l/min	2,5	19	3/4	293 x 131 x 158	3	RE 80189



WASTE PUMP

MULTITypeSITIONAL PUMP HEAD

Flexible installation

Compact and simple design

Capable of extensive dry running

Filter less

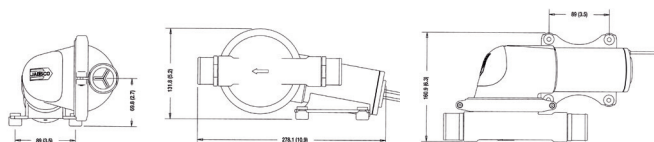

Model	Voltage V	MAX Delivery l/min	Absorption A	Ports mm	inches	Dimension mm	Weight kg	Code
50890	12	19 l/min	8	38	1 1/2	278 x 131 x 160	2	RE 80190
50890	24	19 l/min	2,5	38	1 1/2	278 x 131 x 160	3	RE 80191



ELECTRIC DIAPHRAGM PUMPS

Corrosion resistant

Right for small vessels

Self-priming up to 2m vertical lift

Connections for 3/4" (19mm) Id hose

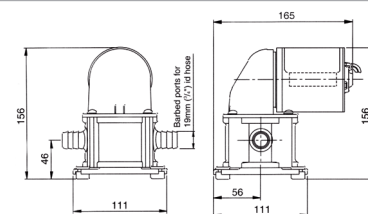

Model	Voltage V	MAX Delivery l/min	Absorption A	Ports mm	inches	Dimension mm	Weight kg	Code
37202 II°	12	13 l/min	7,5	19	3/4	187 x 136 x 153	2,5	RE 80016
37202 II°	24	13 l/min	6,5	19	3/4	187 x 136 x 153	2,5	RE 80017



SELF PRIMING BILGE PUMP

Applications: right for cleaning deck, emptying the bilge, transfer fresh water
Body: bronze

Model	Volt V	Delivery l/min	Absorption A	Ports mm inches	Dimensions mm	Preval. m	Weight gr	Code
Little	12	30	7,5	19 1/2"	160 x 120 x 80	5	2100	RE 80004
Little	24	30	4	19 1/2"	160 x 120 x 80	5	2100	RE 80005
Big	12	45	12	19 1/2"	180 x 120 x 80	7	2300	RE 80068
Big	24	45	6	19 1/2"	180 x 120 x 80	7	2200	RE 80069



ELECTRIC PUMP WITH RUBBER GEARS

Self-priming electric pump with rubber gears
Fitted with waterproof cable guide and internal brush holder with EMI filter
Ideal for bilge and waste water on any type of boat



Model	Volt V	Delivery l/min	Pressure bar	Absorption A	Self-priming m	Ports inches	Code
UP1-J	12	25	1	8	1.5	3/8 BSP	RE 80116
UP1-J	24	25	1	4	1.5	3/8 BSP	RE 80117
UP1	12	35	1	10	1.5	1/2 BSP	RE 80118
UP1	24	35	1	5	1.5	1/2 BSP	RE 80119
UP1-M	12	45	1,5	14	1.5	1/2 BSP	RE 80120
UP1-M	24	45	1,5	7	1.5	1/2 BSP	RE 80121



ELECTRIC PUMP WITH BRONZE GEARS

Applications: transfer of various liquids (intermittent use)
Self priming electric pump with bronze gear
Body: OT58 brass
Gear: bronze
Shaft: aisi 303 stainless steel
Seal: rubber lip seal motor: permanent magnets with brushes
Ports: 3/8" BSP inner thread and Ø14 mm bore hose connections
Degree of protections: IP55



Model	Volt V	Delivery l/min	Absorption A	Self-priming m	Ports mm inches	Dimensions mm	Weight Kg	Code
UP2	12	10	2,8-3,2	1,5m	12 3/8"	128 x 114 x 73	1,2	RE 80128
UP2	24	10	1,4-1,6	1,5m	12 3/8"	128 x 114 x 73	1,2	RE 80135
UP3	12	15	5-6	1,5m	12 3/8"	170 x 167 x 95	1,5	RE 80028
UP3	24	15	3-4	1,5m	12 3/8"	170 x 167 x 95	1,5	RE 80029
UP6	12	26	9-11	1,5m	16 1/2"	199 x 174 x 108	3,1	RE 80030
UP6	24	26	5-6	1,5m	16 1/2"	199 x 174 x 108	3,1	RE 80031
UP12	12	40	20	4m	16 1/2"	212 x 174 x 109	4,3	RE 80194
UP12	24	40	11	4m	16 1/2"	212 x 174 x 109	4,3	RE 80195
UP14	12	46	16	4m	19 3/4"	228 x 225 x 119	5,3	RE 80196
UP14	24	46	8	4m	19 3/4"	228 x 225 x 119	5,3	RE 80197



ELECTRONIC WATER PRESSURE PUMPS

Voltage supply:12/24V
Integrated check valve

Model	Volt V	Delivery l/min	Pressure MAX Bar	Absorp. A	Self-priming m	Ports inches	Dimensions mm	Code
UP2/E	12/24	10	2	2,8 - 3,2	1	3/8"	169x116x73	RE 80136
UP3/E	12/24	15	2,5	5 - 6	1,5	3/8"	172x187x98	RE 80137
UP6/E	12/24	26	2,5	9-11	2	1/2"	240x213x108	RE 80138
UP12/E	12/24	36	3	18-19	3	1/2"	250x213x108	RE 80139
UP14/E	12/24	46	2,5	18-9	3	3/4"	256x225x119	RE 80140



SHOWER KIT

Shower kit complete with self-priming pump with electronics control.
Equipped with helical PTFE gears, nickl-plated brass body and connections, integrated check valve.
Complete with 4m white hose with screw connetcions and hand washer equipped with built-in white container.
The kit is especially suitable for yachts, rubber dinghies and sailing boats.

Model	Volt V	Delivery l/min	Pressure bar	Absorp. A	Self-priming m	Ports inches	Dimensions mm	Code
SP2	12/24	10	1,5	5	1	3/8 BSP	162x105x73	RE 80115

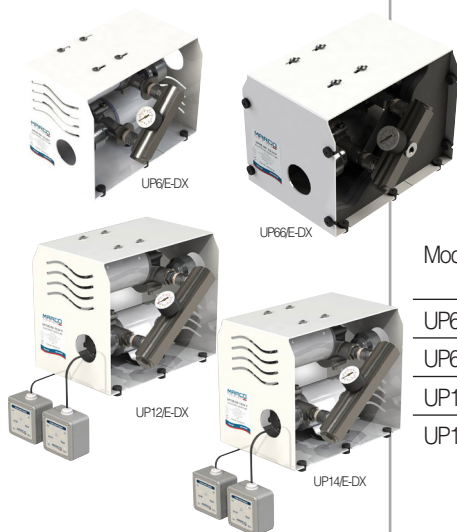

SELF-PRIMING AUTOCLAVES

Self-priming water pressure systems with two connected pumps with electronic control Speed motor related to the flow rate. Reduced consumption and noise. Accumulator tank is not required. Protected against overloads. Pump functions monitored by 2 led. "Empty tank" signal and shut-off device.

Model	Voltage. V	Flow rate l/min	Pressure MAX Bar	Consump. A	Self-priming m	Ports	Dimensions mm	Code
UP6/E-DX	24	52	3,5	8	1,5	3/4" BSP	300x235x282	RE 80295
UP66/E-DX	24	66	3,5	15	2	3/4" BSP	300x265x295	RE 80296
UP12/E-DX	24	72	2,5	20	3	1" BSP	300x265x297	RE 80297
UP14/E-DX	24	92	3,5	18	3	1" BSP	300x250x295	RE 80298



DECK WASHING PUMP

Complete kits including an automatic self-priming electric pump equipped with helical PTFE gears, in-line filter, nickel plated brass body and check valve.
Equipped with quick-click connection, stop-jet, check valve and trigger with jet regulation
The kit are particularly suitable for washing operations either with salt or fresh water

Model	Volt V	Pressure MAX bar	Consump. A	Self-priming m	Ports inches	Dimensions mm	Code
DP3/E	12/24	3	10	1,5	3/8" BSP	188,8x101x187	RE 80142
DP9/E	12/24	4,5	12	1,5	3/8" BSP	224x103x224	RE 80164
DP12/E	12/24	6	24	3	3/8" BSP	240x109x193	RE 80166

PUMPS TRANSFER OIL AND DIESEL

MARCO®

OCK1-E SERIES FOR REVERSIBLE OIL CHANGE

Compact size oil change and diesel transfer kit, fitted with an electronic control panel which guarantees variable speed of the motor in relation to the viscosity of the fluid, the possibility of reversing the flow and a 12/24V universal voltage. Supplied with all necessary accessories.

Model	Voltage V	Self-priming m	Pressure bar	Delivery l/h			Absorp. A	Fusibile A	Ports	Code
				6 mm	8 mm	13 mm				
OCK1-E	12/24	1	2	20	60	330	6	7,5	3/8" BSP	RE 80024



SELF-PRIMING ELECTRIC PUMP FOR LUBRICATING OILS DIESEL AND VISCOUS

Self-priming electric pump with bronze gears for transferring lubricating oils, diesel and viscous. Brass gears, pump body and connections in nicked brass, shaft in stainless steel - Seals in FKM and O-ring in NBR.

Model	Voltage V	Self-priming m	Pressure bar	Delivery l/h	Consump. A	Fuse A	Ports	Code
UP3/AC	220	1,5	6	10	0,8	1,25	3/8"	RE 80149
UP6/AC	220	1,5	5	28	1,7	3	1/2"	RE 80150
UP14/AC	220	3	4	44	1,7	3	13 mm	RE 80151



PORTABLE KIT FOR DIESEL REFUELING

Self-priming impeller electropump provided with integrated by-pass valve. Body in aluminium with double connection. Carter with knob, on/off switch and battery clamps. Water pistol, 2.5m aspiration pipe with filter and 4m of outlet pipe.

Model	Voltage V	Self-priming m	Pressure bar	Delivery l/min	Consump. A	Fuse A	Ports mm	Code
VP45-K	12	1,5	1,2	45	8-19	20	25	RE 80046
VP45-K	24	1,5	1,2	45	4-9,5	10	25	RE 80047



OIL CHANGE KIT REVERSIBLE

Kit with membrane panel, electronically controlled by a membrane panel. Designed for oil fill and drain operations. Electronic regulation according to oil viscosity/temperature. Automation block in case of empty tank, short circuit or after 30 minutes of operation.

Model	Voltage V	Self-priming m	Pressure bar	Delivery l/min	Absorp. A	Dimension mm	Inch fittings	Code
UP3-RK	12/24	1,5	2	15	4/2	159x166x101	3/8 BSP	RE 80042
UP6-RK	12/24	1,5	2	26	5/2,5	199x174x108	1/2 BSP	RE 80043



ELECTRIC GEAR PUMP

Applications: transfer of lubricating oil or viscous liquids. Self-priming electric pump with bronze gear. Body: OT58 brass. Gear: bronze. Shaft: aisi 303 stainless steel. Seal: rubber lip seal. Motor: permanent magnets with brushes. Ports: two brass connections for Ø14mm inner tube and one quick fit connection for 8mm external tubing. Degree of protection: IP55.

Model	Volt V	Delivery l/h			Absorption A	Ports		Dimensions mm	Weight Kg	Code
		Ø6	Ø8	Ø14		p. rubber	riisan			
UP2/OIL	12	18	54	200	2,3 - 2,7	12 mm	8 mm	128 x 106 x 73	1,2	RE 80177
UP3/OIL	12	20	60	330	5,5 - 6,5	14 mm	8 mm	149 x 99 x 86	1,4	RE 80168
UP9/OIL	24	25	75	480	3,5 - 4,5	14 mm	8 mm	166 x 99 x 94	2,5	RE 80178
UP12/OIL	24	360L/h(Ø12) 900L/h(Ø16)			5,5 - 6,5	16mm X2		195 x 122 x 109	4	RE 80179

Kit Rilsan tubing Ø 8mm and 6mm external 5 m

RE 80170

FLOATING SWITCHES



FLOATING SWITCH

Fully sealed. Against deflagration materials.

Model	Voltage V	Power MAX	External Dimensions MAX	Code
Ocean	10-32	15 A	110 x 70 x 50 mm	RE 80010



ELECTRONIC SWITCHES FOR BILGE PUMPS

Operation by microcontroller. Advanced digital filter to detect the presence of water. Remote indication of operation status by led (optional). Manual remote pump switch-on by button (optional). Signal for prolonged bilge pump switch on (if led is installed). Protection against excessive battery rundown. Switch on (5 sec) switch off (20 sec) delay to avoid false. Switch-on switch-off cycling of the pump caused by the roll of the boat. Watertight case.

Model	Voltage V	Power MAX	External Dimensions MAX	Absorp. When idling	Sensor number	Code
EBSN 10	12-24	10 A	75 x 83 x 38 mm	7,5 mA	2 inox	RE 80105
EBSN 15	12-24	15 A	75 x 83 x 38 mm	7,5 mA	2 inox	RE 80106
EBSN 20	12-24	20 A	75 x 83 x 38 mm	7,5 mA	2 inox	RE 80107



FLOATING SWITCH RULE-A-MATIC®

Quiet running. Fully sealed. Against explosion

Model	Voltage V	Power MAX	External Dimensions MAX	Code
35	10-32	14 A	114 x 38 x 51 mm	RE 80212



FLOATING SWITCH "SUPER SWITCH"

For pump of high absorption. External material and electric contact of high quality. Cable with double insulation.

Model	Voltage V	Power MAX	External Dimensions MAX	Code
37	10-32	20 A	114 x 38 x 51 mm	RE 80235



PLUS FLOATING SWITCH RULE-A-MATIC®

With external protection against collisions, rubbles and obstacles. Special wires covering, resistant to abrasions. The wire come out of the upper part of the float.

Model	Voltage V	Power MAX	External Dimensions MAX	Code
40	10-32	20 A	65 x 123 x 70 mm	RE 80211



FLOATING SWITCH "HYDRO AIR"

Ultra reliable bilge switch. Its particular structure avoids the installation of mobile parts on the bilge. When the water level increases, the air is pulled into the pipe (length 3m). Against explosions (ISO 8846). The air activates the diaphragm switch which is always out of the water.

Model	Voltage V	Power MAX	External Dimensions MAX	Switch		Code
				ON	OFF	
Hydro Air	12	20 A	78 x 140 x 47 mm	55 mm	25 mm	RE 80216
Hydro Air	24	10 A	78 x 140 x 47 mm	55 mm	25 mm	RE 80217



FLOATING SWITCH

Model	Voltage V	Power MAX	External Dimensions MAX	Code
AS3	10-32	10 A	113 x 83 x 62 mm	RE 80097

CONTROL SWITCH FOR BILGE PUMPS

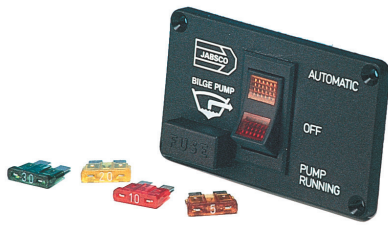

CONTROL SWITCH FOR BILGE PUMPS

In robust plastic material, waterproof.
With fuse holder and 4 fuses of 5-10-20-30A.
Carling switch with double indicator light at three position (AUTO-OFF-ON).
Orange indicator light: shows that automatic mode is set.
Red lights: shows whenever pumps run.



Model	Voltage V	Power MAX	Indicator lights	Fuse glass	IP	Dimensions mm	Inlet hole mm	Code
Bilge master	12-24	30 A	2	SI	65	100 x 60 x 65	55 x 45	RE 80011

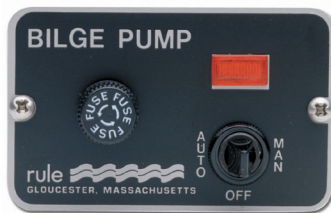

CONTROL SWITCH FOR BILGE PUMPS

Made of black, water-resistant stainless steel.
With fuse holder for glass fuse 6,3x32 (not included).
For use with automatically controlled bilge pumps.



Model	Voltage V	Power MAX	Indicator lights	Fuse glass	IP	Dimensions mm	Inlet hole mm	Code
41	12	20 A	1	6,3 x 32	65	83 X 51 x 65	51 x 83	RE 80221
42	24	10 A	1	6,3 x 32	65	83 X 51 x 65	51 x 83	RE 80222

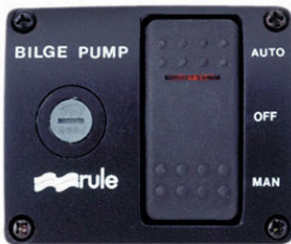

CONTROL SWITCH FOR BILGE PUMPS

In robust plastic material, waterproof.
With fuse holder for glass fuse 6,3x32 (not included).
3-way switch with red led indicator.



Model	Voltage V	Power MAX	Indicator lights	Fuse glass	IP	Dimensions mm	Inlet hole mm	Code
43	12	20 A	1	6,3 x 32	65	75 x 63 x 60	55 x 43	RE 80171
44	24	20 A	1	6,3 x 32	65	75 x 63 x 60	55 x 43	RE 80172



CONTROL SWITCH FOR BILGE PUMPS

Reduced dimensions.
In stainless steel.
3-way toggle switch (AUTO-OFF-ON).



Model	Voltage V	Power MAX	Indicator lights	Fuse glass	IP	Dimensions mm	Inlet hole mm	Code
45	12-24	20 A	NO	NO	65	58 x 51 x 45	35 x 25	RE 80210



CONTROL SWITCH FOR BILGE PUMPS IP67

Aluminium panel with.
3-way carling switch (AUTO-OFF-ON).
With watertight fuse holder.
Included 15A glass fuses. Max power: 20A at 12Vdc - 15A at 24Vdc.
Vertical installation.



Model	Voltage V	Power MAX	Indicator lights	Fuse glass	IP	Dimensions mm	Inlet hole mm	Code
VERTICAL	12-24	20 (15) A	1	6,3 x 32	67	58 x 95 x 45	30 x 65	RE 80108



WATER DEPURATION FILTER

Housing in nickel brass
Filter in stainless steel
Cover in transparent polycarbonate
Available at 3/8", 1/2" and 3/4"

Connections inches	Delivery l/h	Dimensions mm	Materials	Approval	Code
3/8	-	105x99	Nickel brass	RINA	RE 80087
1/2	2550	105x99	Nickel brass	RINA	RE 80088
3/4	4750	105x99	Nickel brass	RINA	RE 80089



WATER FILTERS

Applications: cooling sea water
They are installed on the motor water intake
Body in nickel-plated brass, cover in transparent polycarbonate
Stainless steel aisi 316 filter
R.I.N.A approvals

Connections inches	Delivery l/h	Dimensions mm	Weight Kg	Materials	Approval	Code
3/8"	1230	Ø 110 x 140	2,5	Nickel-plated brass	RINA	RE 81065
1/2"	1740	Ø 110 x 140	2,5	Nickel-plated brass	RINA	RE 81066
3/4"	2880	Ø 146 x 160	3	Nickel-plated brass	RINA	RE 81067
1"	4580	Ø 146 x 160	3,5	Nickel-plated brass	RINA	RE 81068
1" 1/4	6000	Ø 170 x 215	6	Nickel-plated brass	RINA	RE 81069
1" 1/2	7200	Ø 170 x 215	6	Nickel-plated brass	RINA	RE 81070
2"	8640	Ø 188 x 235	6	Nickel-plated brass	RINA	RE 81071
2" 1/2	12000	Ø 230 x 280	12	Nickel-plated brass	RINA	RE 81072
3"	15400	Ø 230 x 315	15	Nickel-plated brass	RINA	RE 81073
4"	20000	Ø 220 x 410	18	Nickel-plated brass	RINA	RE 81079

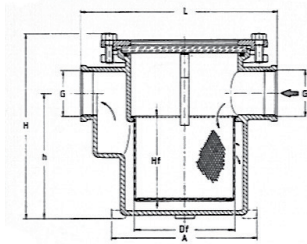

WATER FILTERS

Applications: cooling sea water
They are installed on the motor water intake
Body in nickel-plated brass, cover in transparent polycarbonate
Stainless steel aisi 316 filter
R.I.N.A approvals

Connections inches	Delivery l/h	Dimensions mm	Weight Kg	Materials	Approval	Code
3/4"	3000	Ø 108 x 143	3	Nickel-plated brass	RINA	RE 81074
1"	5000	Ø 108 x 143	3,5	Nickel-plated brass	RINA	RE 81075
1" 1/4	8000	Ø 134 x 175	6	Nickel-plated brass	RINA	RE 81076
1" 1/2	12000	Ø 134 x 175	6	Nickel-plated brass	RINA	RE 81077
2"	19000	Ø 165 x 210	6	Nickel-plated brass	RINA	RE 81078

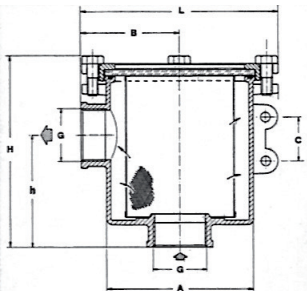

**PUMPGUARD**

Simply installed. Prevents unnecessary pump breakdowns.
Plastic body, 40 mesh stainless steel screen.
Screw off top allows quick in place cleaning and removal of debris.
Transparent housing allows instant inspection.

FLOJET

Model	Connections		Inlet hole mm	Dimensions mm	Code
	mm	inches			
IN LINE FILTER	13	1/2"	Ø9	72 x 122 x 58	RE 81046
IN LINE FILTER	19	3/4"	Ø 13,5	72 x 122 x 58	RE 81047

**IN LINE NON RETURN VALVES**

Prevent backflow of water into the bilges. Simply fit into hand or electric pumps

Model 29295-1011 In line non-return valve for 3/4" (19mm).

RE 80132

Model 29295-1000 In line non-return valve for 1" (25mm).

RE 80133

Model 29295-1010 In line non-return valve for 1 1/2" (38mm).

RE 80134

**BILGE STRAINERS**

Stop bilge debris blocking inlet suction hose
Reduce the risk of debris entering and blocking the pump
Re-positional ports allow horizontal, vertical or sideways hose attachment

JABSCO

Model	Weight kg	Dimensions mm	Ports		Code
			mm	inches	
29290-1020	0,1	170x72x60	19	3/4	RE 81062
29290-1000	0,1	170x72x60	25	1	RE 81063
29290-1010	0,1	170x72x60	38	1 1/2	RE 81064

**AQUA FILTRA**

It absorbs dissolved impurities freshening and cleaning the water. Beneficial mineral salts are retained. Initial flow capacity up to 14 lpm. Replacement filter cartridge available on request.

JABSCO

Item	Model	Weight kg	Dimensions mm	Max Pressure bar	Code
Filter	59000-1000	0,5	230x140x100	4,3	RE 81048
Spare part	59100-0000	0,5	230x140x100	4,3	RE 81049

**ACCUMULATOR TANKS**

Reduce the frequency of clutch or unclutch of the pump.
Regularize the water pressure of the system. Longer pump life, lower battery drain.

Model	Type	Material	Press Max	Dimensions	Weight	Code
1,2 LITER	Pressurized tank	Plastic	7 bar	Ø100 x 350 mm	0,7 Kg	RE 81050
5 LITER	Tank	Sheet metal	10 bar	Ø200 x 330 mm	3,75 Kg	RE 80067
20 LITER	Tank	Stainless steel	10 bar	Ø300 x 270 mm	5,6 Kg	RE 80160

**STAINLESS STEEL ACCUMULATOR TANK 2 L WITH 1/2" T-NIPPLE****MARCO**

Stainless steel accumulator tank for automatic pumps. Stainless steel connection.
Butyl membrane for liquid foodstuff.

Model	Type	Material	Press max	Dimensions	Weight	Code
ATX2	Accumulator tank	stainless steel AISI 304	10 bar	Ø138 x 274 mm	0,76 Kg	RE 80159



FLEXIBLE IMPELLER

Are subjected to usury, replace all impellers at least once every year.

Blades n°	Diameter Ø (A)	Height (B)	Hole Ø (C)	Drive type	Material insert	Impeller outline	Material impeller	Code
6	51 mm	22 mm	12,7 mm	1 - 2	Bronze	G	NEOPRENE	RE 81051
9	95 mm	63 mm	25 mm	7	Bronze	O	NEOPRENE	RE 81052
8	65 mm	50,2 mm	16 mm	7	Bronze	A	NEOPRENE	RE 81053
12	57 mm	31,5 mm	16 mm	7	Bronze	K	NEOPRENE	RE 81054
6	40 mm	19 mm	9,5 mm	1 - 2	Bronze	D	NEOPRENE	RE 81055
8	65 mm	75,4 mm	16 mm	7	Bronze	M	NEOPRENE	RE 81056
12	95 mm	63 mm	25 mm	7	Bronze	Q	NEOPRENE	RE 81057
12	95 mm	88,4 mm	25 mm	7	Bronze	Q	NITRILE	RE 81058
10	65 mm	50,2 mm	16 mm	7	Bronze	Y	NEOPRENE	RE 81059
10	51 mm	22 mm	12,7 mm	1 - 2	Bronze	I	NEOPRENE	RE 81060
6	40 mm	19 mm	9,5 mm	1 - 2	Bronze	D	NEOPRENE	RE 81061



ELECTRONIC VALVES FOR FRESH WATER



1/4" PORTS. Maximum pressure 5 bar

Brass body, stainless steel internal sleeve

Applications: wiper system and water distribution on boats

Type	Voltage V	Coil absorption	Hole	Ports inches	MAX Pressure	Flow	Code
EV-MA	12	1 A	Ø 4,5 mm	1/4"	5 bar	21 l/m	RE 80198
EV-MA	24	0,55 A	Ø 4,5 mm	1/4"	5 bar	21 l/m	RE 80199

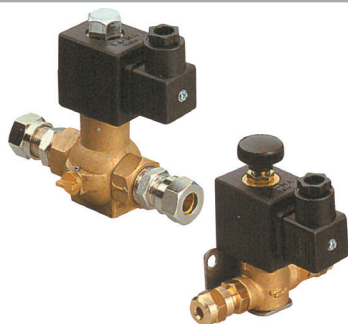

FUEL CUT-OFF SOLENOID VALVES (DIESEL FUEL)



Continuous duty, R.I.N.A approval. Brass body and stainless steel fixing bracket.

Complete with ogive pipe fittings for tubing of various diameters.

Incorporating a hand release knob to open the valve manually in case of electrical failure.

Type	Voltage V	Coil absorption	Hole	Ports inches	Connections Ø mm	Flow l/m	Code
EV-M312	12	1 A	Ø 12 mm	1/2"	12 mm	69	RE 80175
EV-M312	24	0,55 A	Ø 12 mm	1/2"	12 mm	69	RE 80176



ELECTRONIC VALVES FOR FUEL

Continuous duty, UNI EN 28846 approval. Body in brass and stainless steel bracket.

With BYPASS and manual emergency control.

Type	Voltage V	Coil absorption	Hole	Ports inches	Delivery	Code
EL-0511	12	12W	Ø 7 mm	1/2"	100 l/h	RE 80109
EL-0521	24	12W	Ø 7 mm	1/2"	100 l/h	RE 80110
EL-0516	12	12W	Ø 7 mm	1/2"	600 l/h	RE 80111
EL-0526	24	12W	Ø 7 mm	1/2"	600 l/h	RE 80112
EL-1013	12	60W	Ø 25 mm	1"	3350 l/h	RE 80113
EL-1023	24	60W	Ø 25 mm	1"	3350 l/h	RE 80114